

## CAMPING

The FDomes Tent is a perfect combination of modern design and functionality, created with the comfort and convenience of users in mind. Thanks to its well-thought-out design and the use of high-quality materials, the FDomes Tent will work perfectly in both recreational spaces and more demanding conditions. This is a solution that combines aesthetics with practicality, creating a unique space for relaxation close to nature.

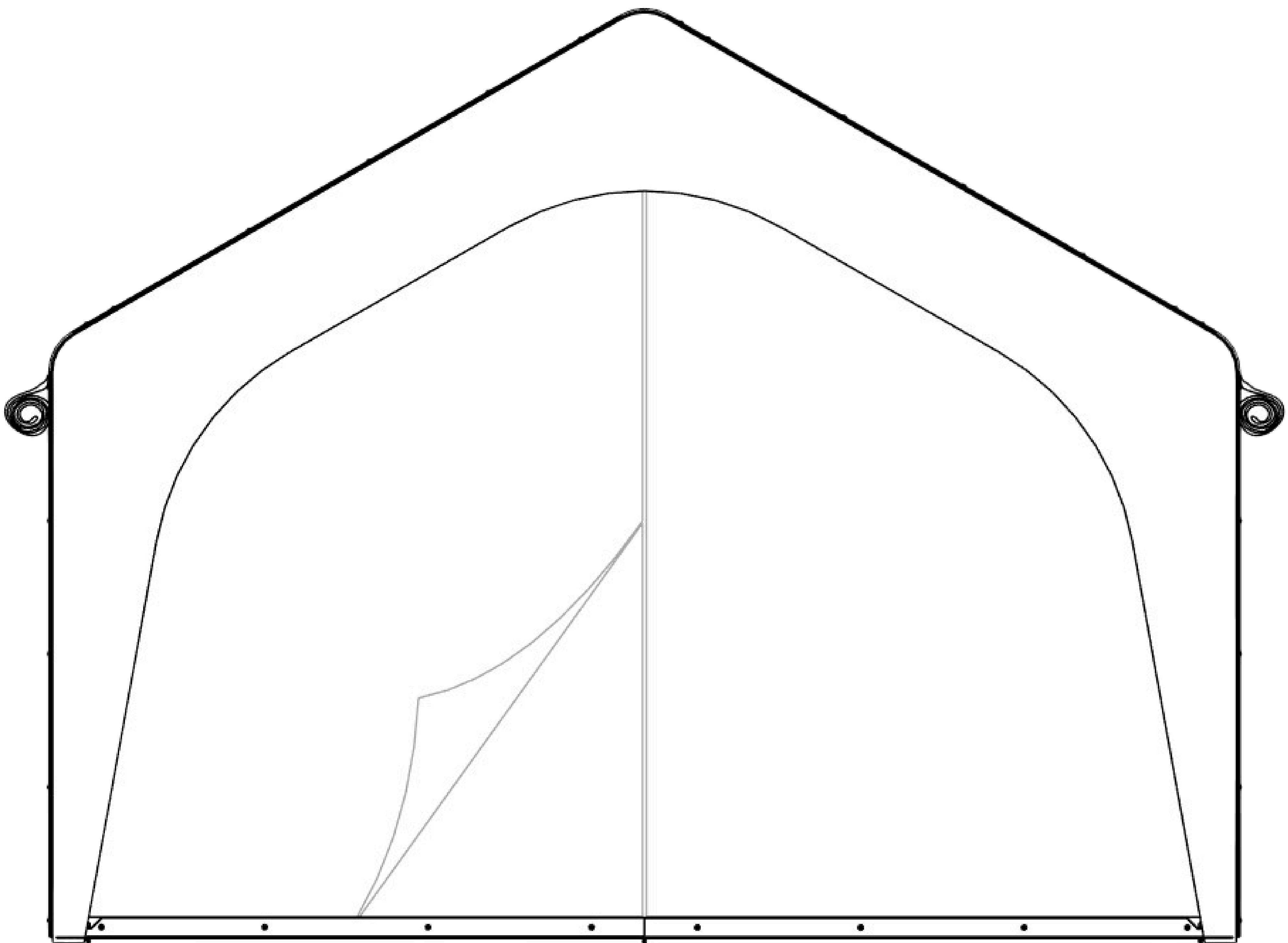

## PRODUCT COMPONENTS

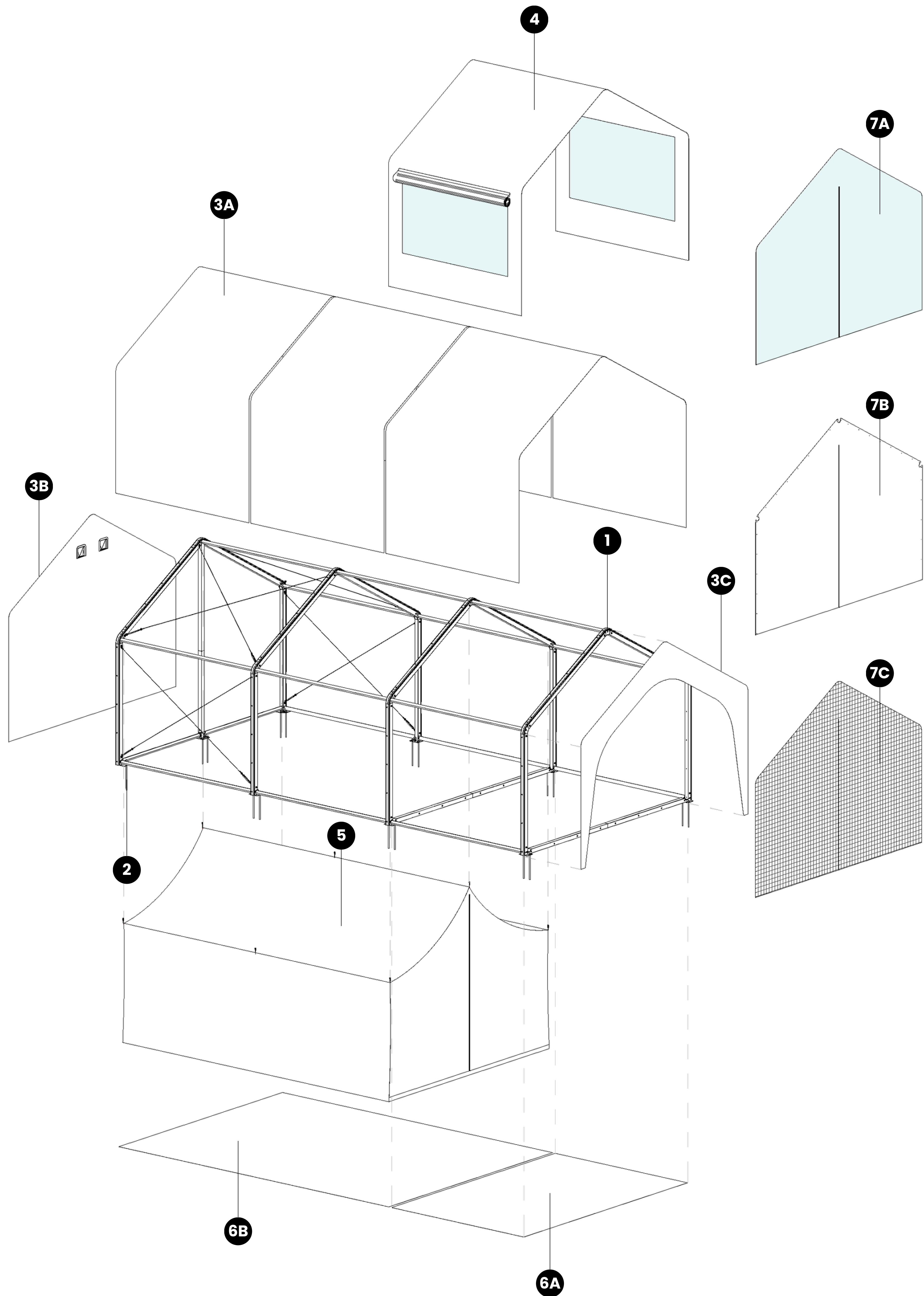

## PRODUCT DESCRIPTION

- 1 Supporting structure:** made of galvanized steel, powder-coated for durability, and assembled using galvanized steel screws. It is reinforced with steel cable braces featuring tension adjustment. A keder strip, made of powder-coated aluminum, is used for mounting the outer cover.
- 2 Anchoring to the ground:** The structure is anchored to the ground using dedicated mounting feet equipped with anchoring holes. The standard product includes a set of screws / anchors, depending on the ground type:
  - Screw-in ground anchors made of plastic (PP)
  - Galvanized steel wood screws
  - Galvanized steel mechanical anchors for concrete

- 3 PVC outer cover:**

Properties:

- Surface weight: 780 g/m<sup>2</sup>
- UV protection
- Light-proof layer in the membrane core
- Matte surface finish
- Resistant to mold and fungi
- High mechanical resistance
- Flame retardant - complies with applicable standards: DIN EN 13501-1 (B-s3, d0); NF P 92-503 (M1); Italia UNI 9177:1987 (CI 2); CSFM19; NFPA701; CPAI84; BS7837; GOST

The outer cover, in its standard form, consists of three roof panels (**3A**), a rear gable wall (**3B**) and a front valance (**3C**). There are ventilation holes in the upper part of the rear gable wall to ensure optimal air circulation.

- 4 Outer cover with the windows:** The tent's porch can be upgraded with two windows, one on each side. The windows are made of transparent PVC and are integrated into the outer cover.
- 5 Inner tent:** The floor of the inner tent is made of a black PVC-coated membrane to protect against ground moisture. The upper part consists of lightweight polyester fabric, also moisture-protected. The entrance to the inner tent is secured with a zipper. Dedicated mounting points attach the inner tent to the supporting structure.

**Properties (floor):**

- Surface weight: 650 g/m<sup>2</sup>
- High resistance to tearing and bursting
- 100% waterproof
- Easy to clean

**Properties (above ground part):**

- Surface weight: 288 g/m<sup>2</sup>
- Waterproof: 80 hPa (wg PN EN ISO 811)
- Easy to clean

- 6 Floor:** the tent can be equipped with a zip-on floor made of black PVC-coated membrane - for additional protection against ground moisture from the ground (the material is the same as the floor of the inner tent). Available in a version for the porch (**6A**) and for the main part of the tent (**6B**).
- 7 Entrance:** attached to the tent structure using snaps, opens with a vertically positioned zipper; available in three variants:
  - 7A:** transparent membrane that that let light in
  - 7B:** PVC membrane with a light-tight core, in the color of the outer cover
  - 7C:** Mosquito net made of black mesh for insect protection

**Maximum loads:**

- Maximum snow load: ~50 kg/m<sup>2</sup> | ~1186 lb/ft<sup>2</sup>
- Maximum wind load: ~80 km/h | ~50 mph

**Packaging information:**

The tent is packed in a box integrated with the pallet.

- Dimensions: 200 x 80 x 55 cm | 78.7" x 31.5" x 21.6" [L x W x H]
- Mass: ~290 kg | ~640 lb

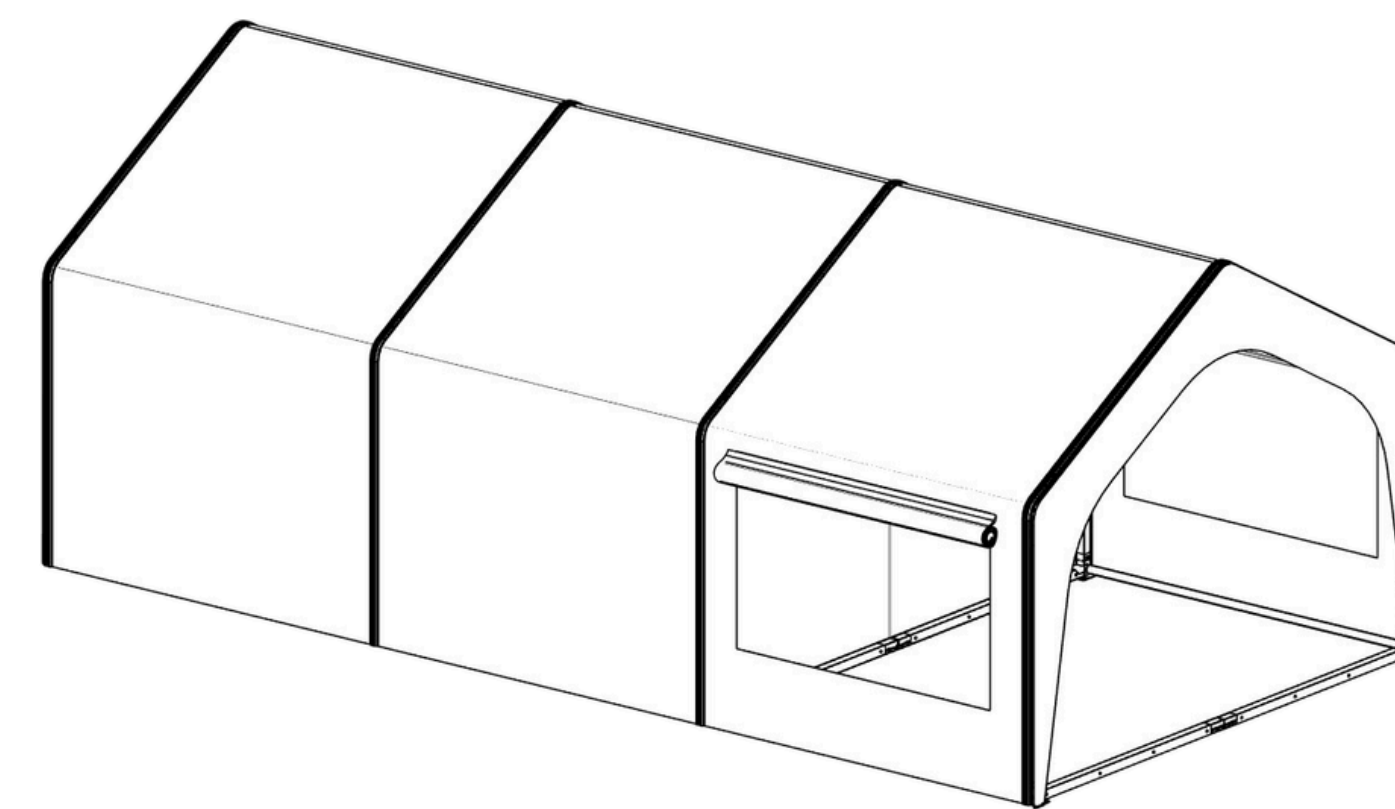

## COLORS

**DESIGN**



\*RAL1019

**PVC OUTER COVER**



\*Similar to RAL1019

**INNER TENT**



\*Similar to RAL1019

**PVC FLOOR**



\*Similar to RAL9005

\*The colors shown are approximate and may differ from the actual appearance of the product. Variations may result from factors such as monitor settings, lighting conditions, the production process, and the materials used. For an exact color match, we recommend referring to a RAL sample or contacting the manufacturer.

## AVAILABLE CONFIGURATIONS

**STANDARD TENT EQUIPMENT**

supporting structure

ground mounting

PVC Outer cover (5 elements)

+

**ADDITIONAL EQUIPMENT**

inner tent

Outer cover with the windows

floor in the porch

floor in the main part

transparent entrance

entrance in the color of the tent

mosquito net

# TECHNICAL DRAWING

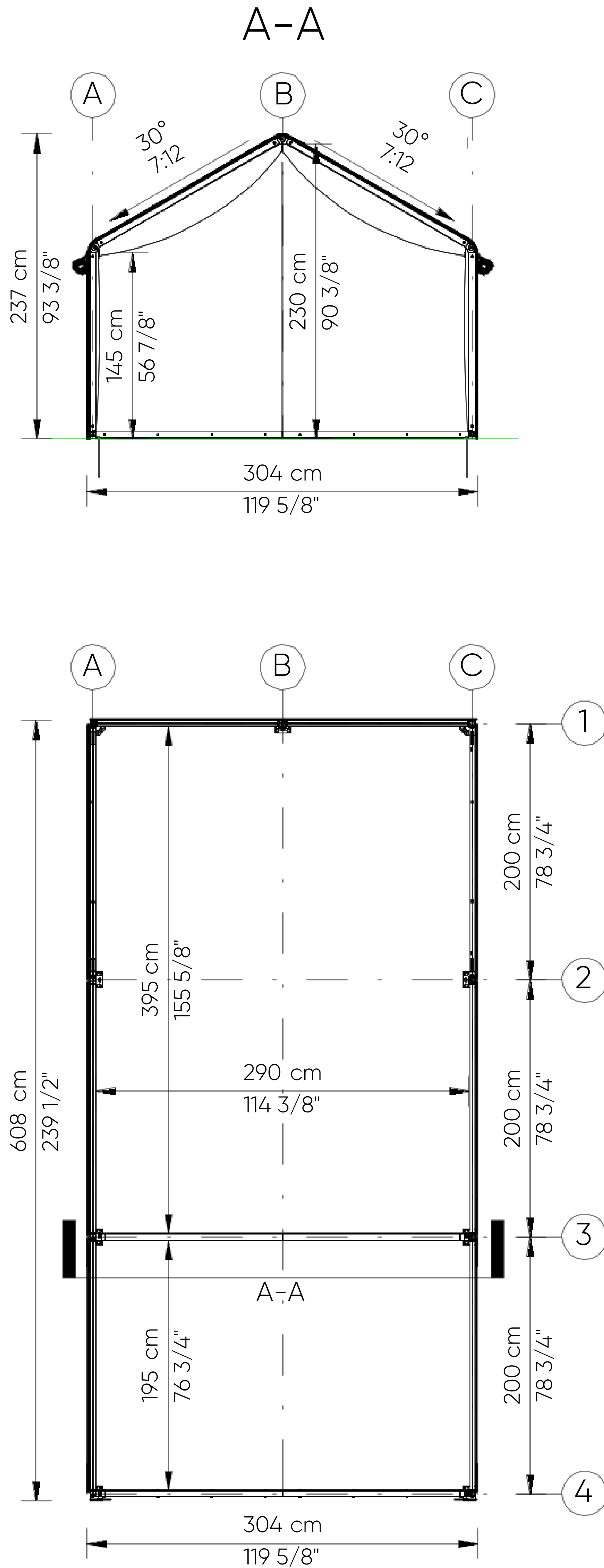

## INTERIOR DESIGN SUGGESTIONS

