

FDOMES MODULES

KITCHEN – ASSEMBLY GUIDE

STEP 1

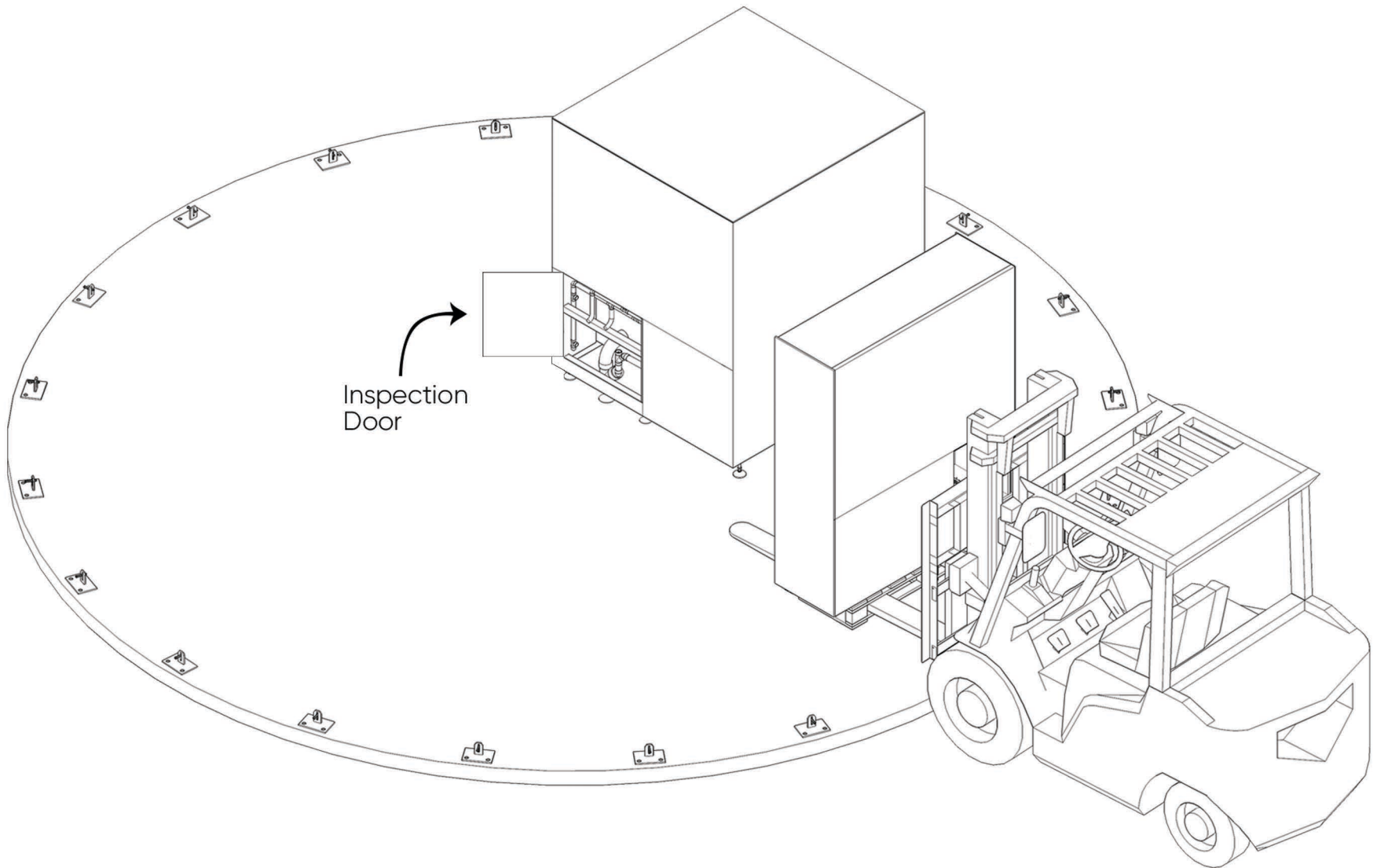

- Place the kitchen module on the floor.
- Remove the pallets from under the module.
- Remove the inspection door (if present) from the bathroom module.

STEP 3

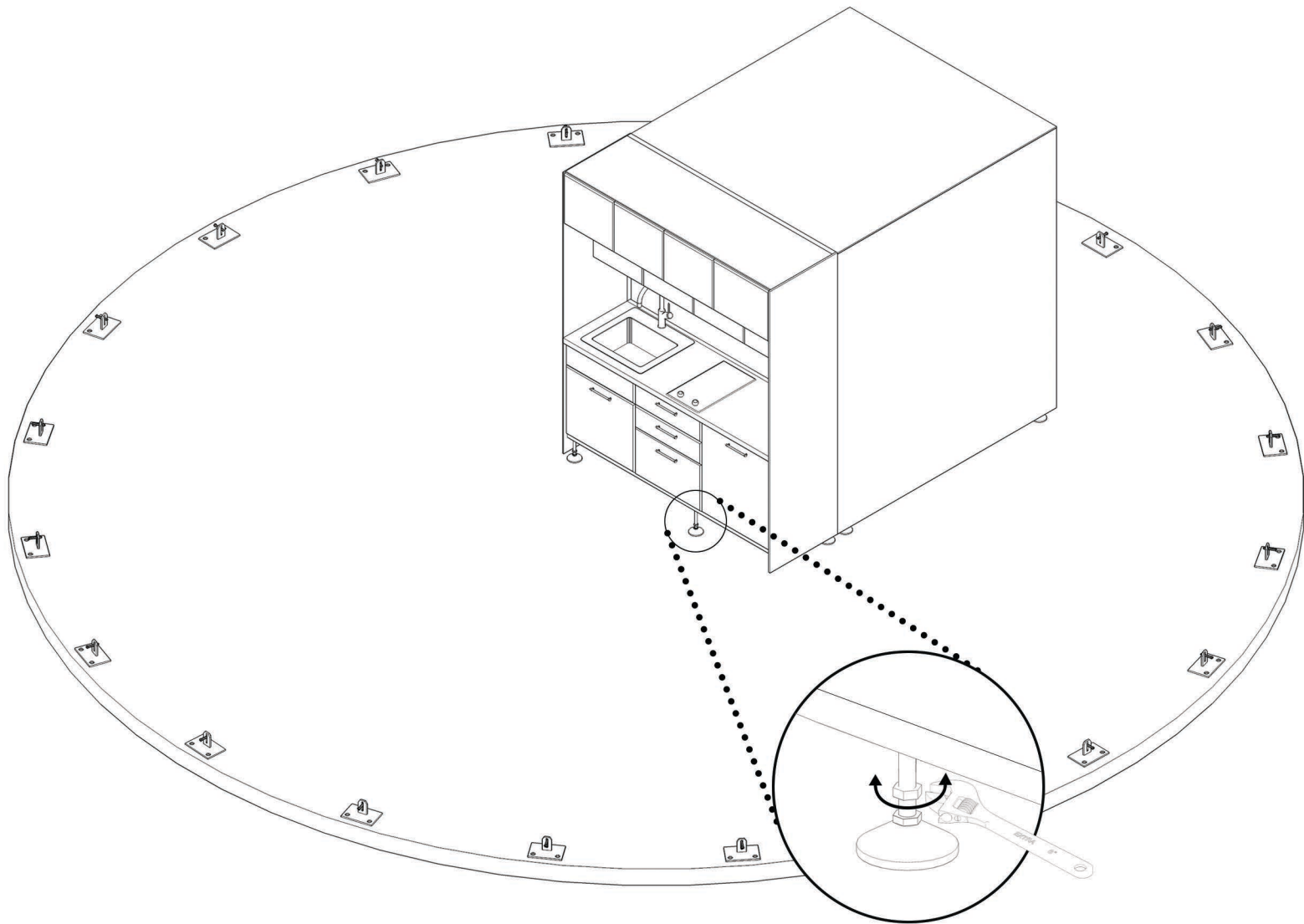

- Level the module using the adjustable feet so that it aligns with the bathroom module.

STEP 3

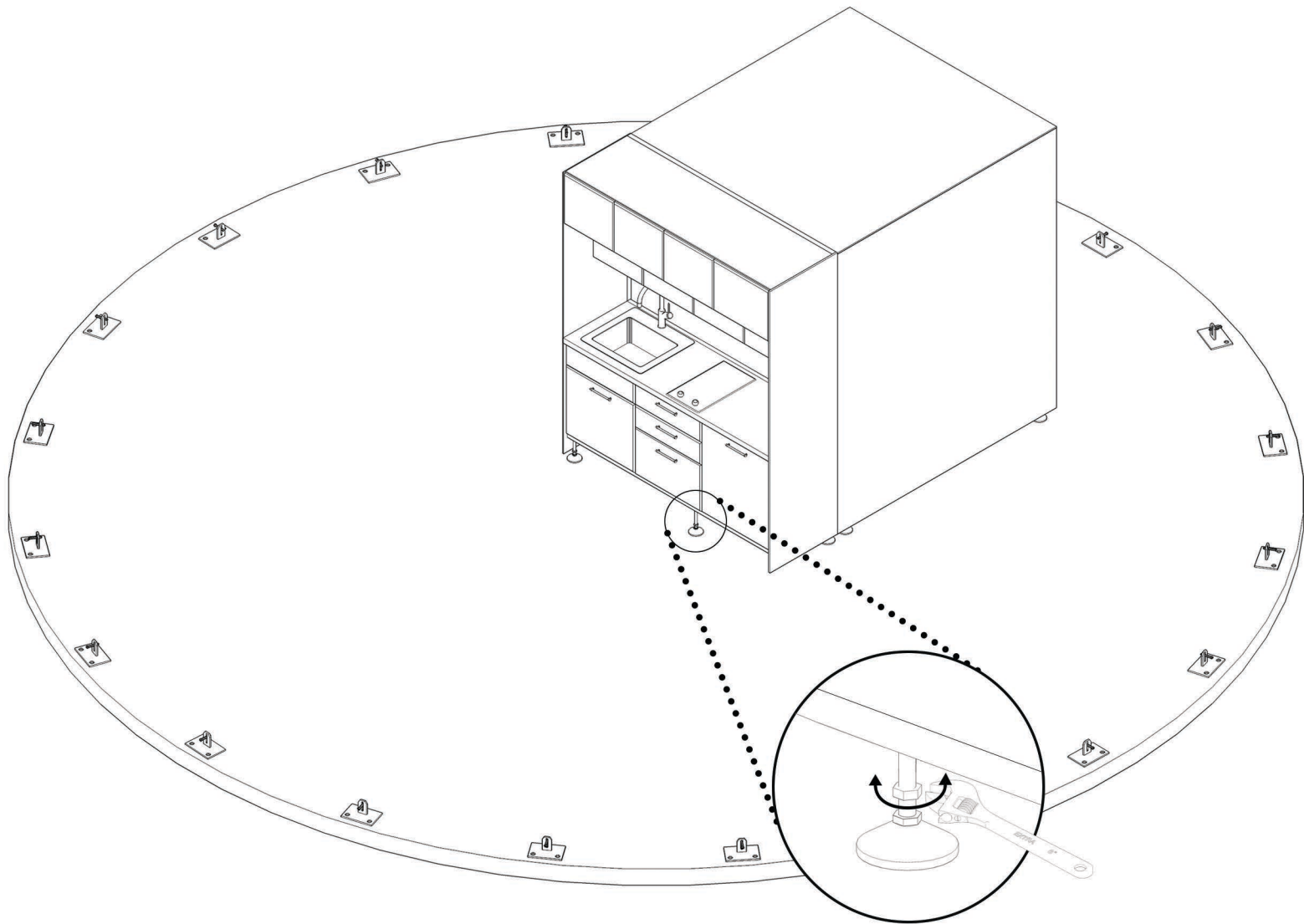

- Level the module using the adjustable feet so that it aligns with the bathroom module.

STEP 4

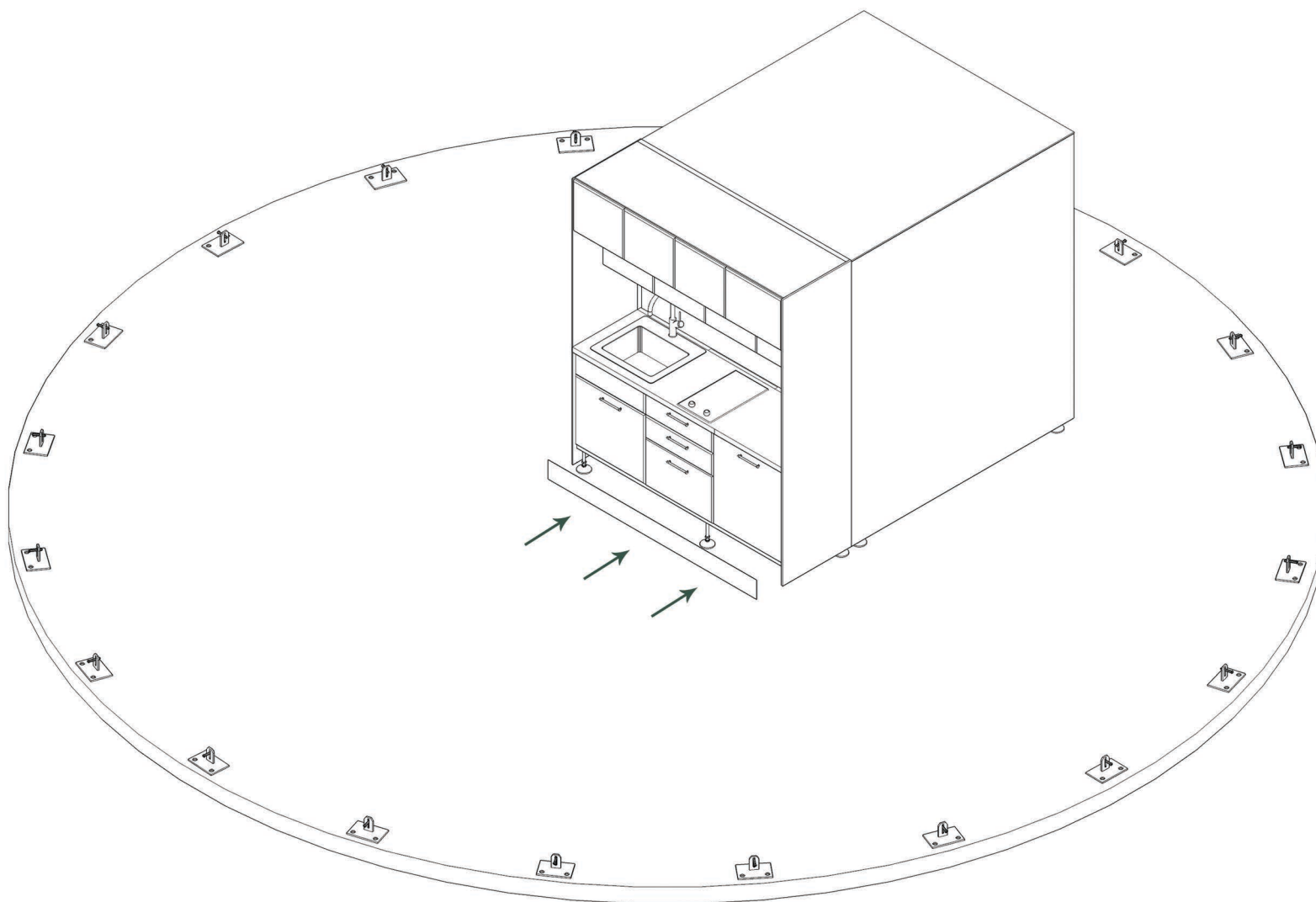

- Assemble plinth kickboard according to the drawing.

STEP 5

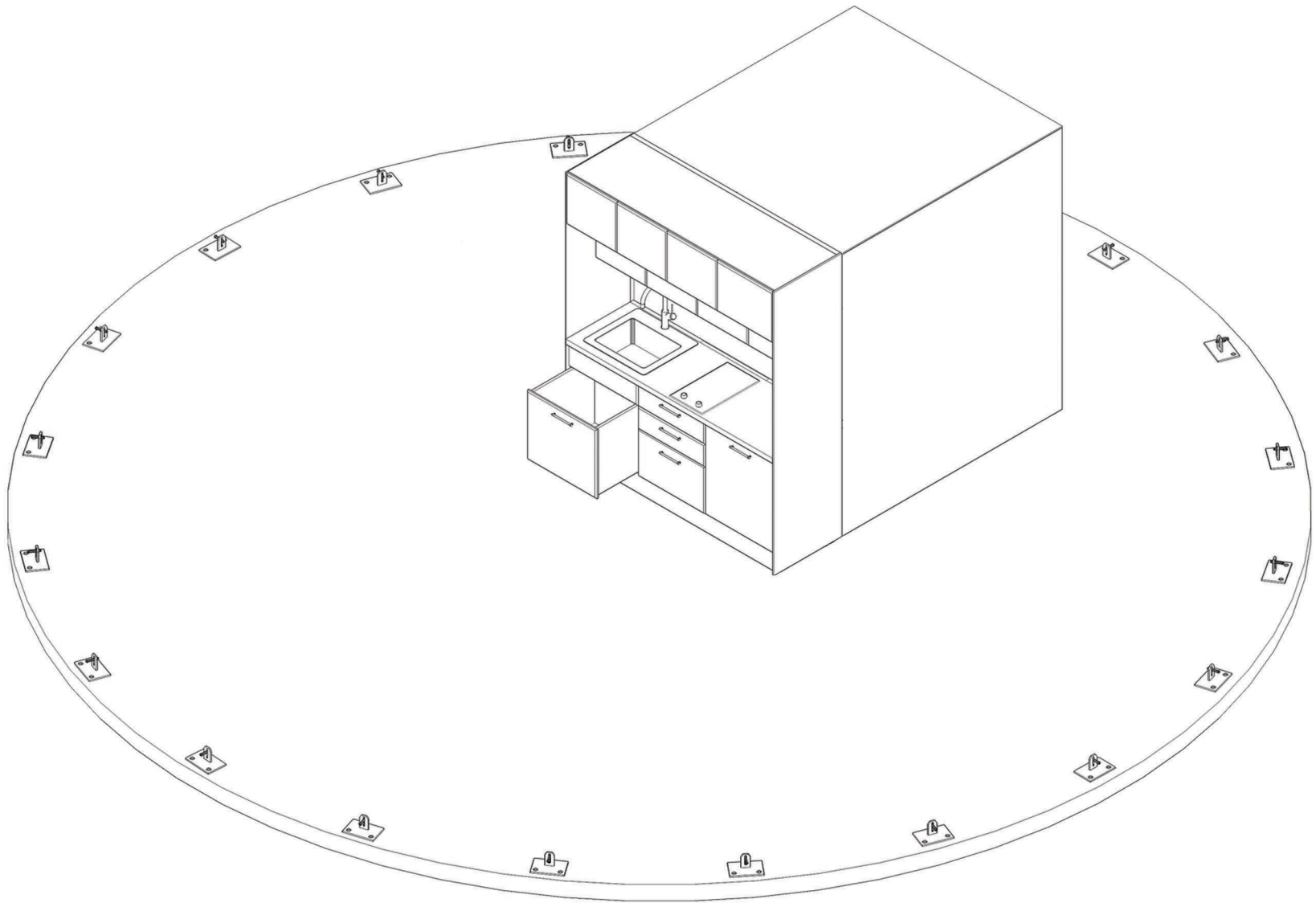

- Pull out and remove the drawer on the left (under the sink).

STEP 6

KITCHEN MODULE

BATHROOM MODULE

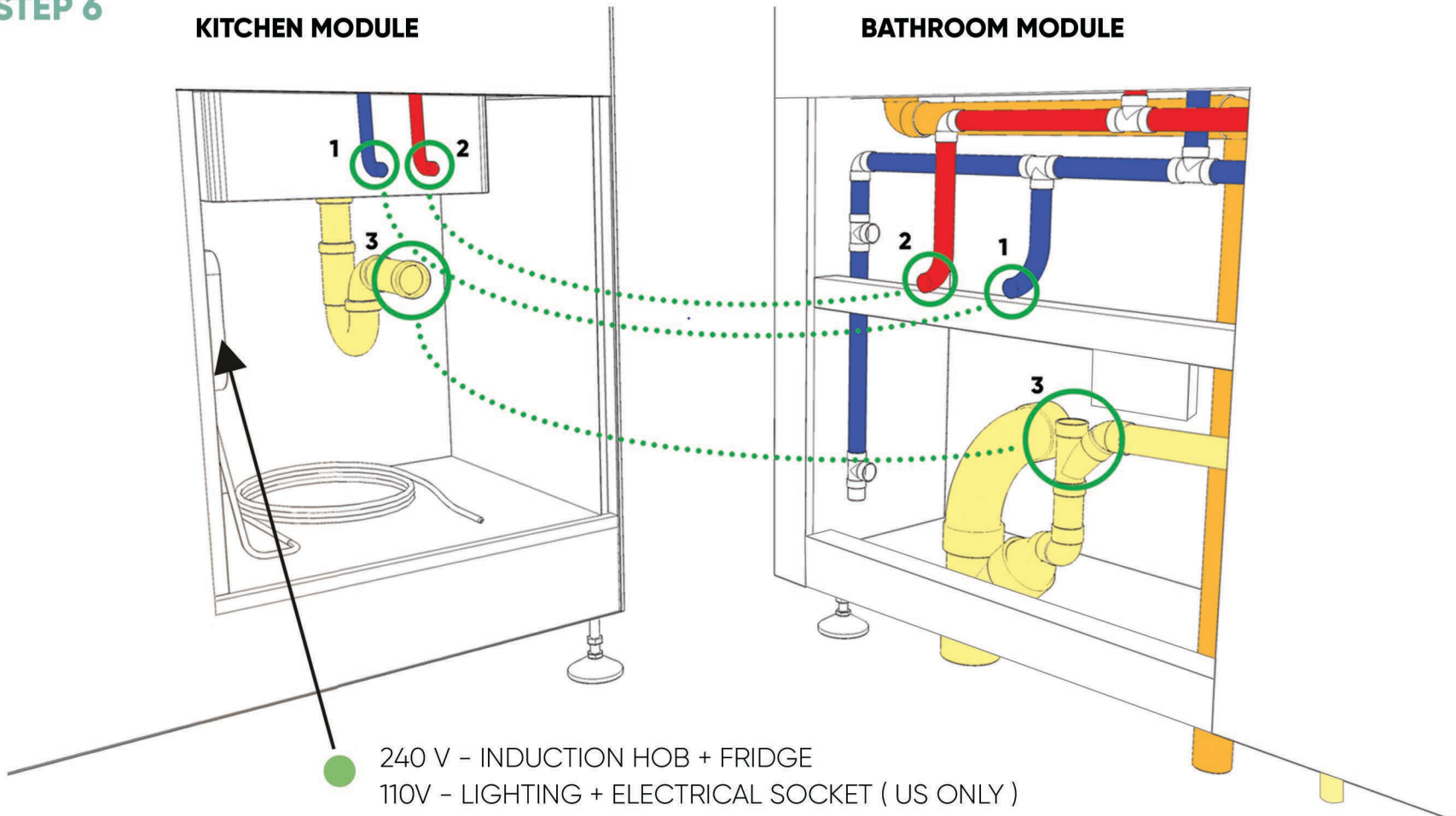

- Through the inspection under the sink, connect the hot and cold water pipes to the valves located in the bathroom module. (When done, open the hot and cold water valves).
- Use the flexible pipe to connect the sink drain to the collective drain in the bathroom module.
- There is an electric box under the sink - connect the 240V power supply to the hob and fridge, then (110V US ONLY) to the power supply of electrical sockets and lighting (all electrical connections must only be made by qualified persons).
- Make sure all connections are tight.

STEP 7

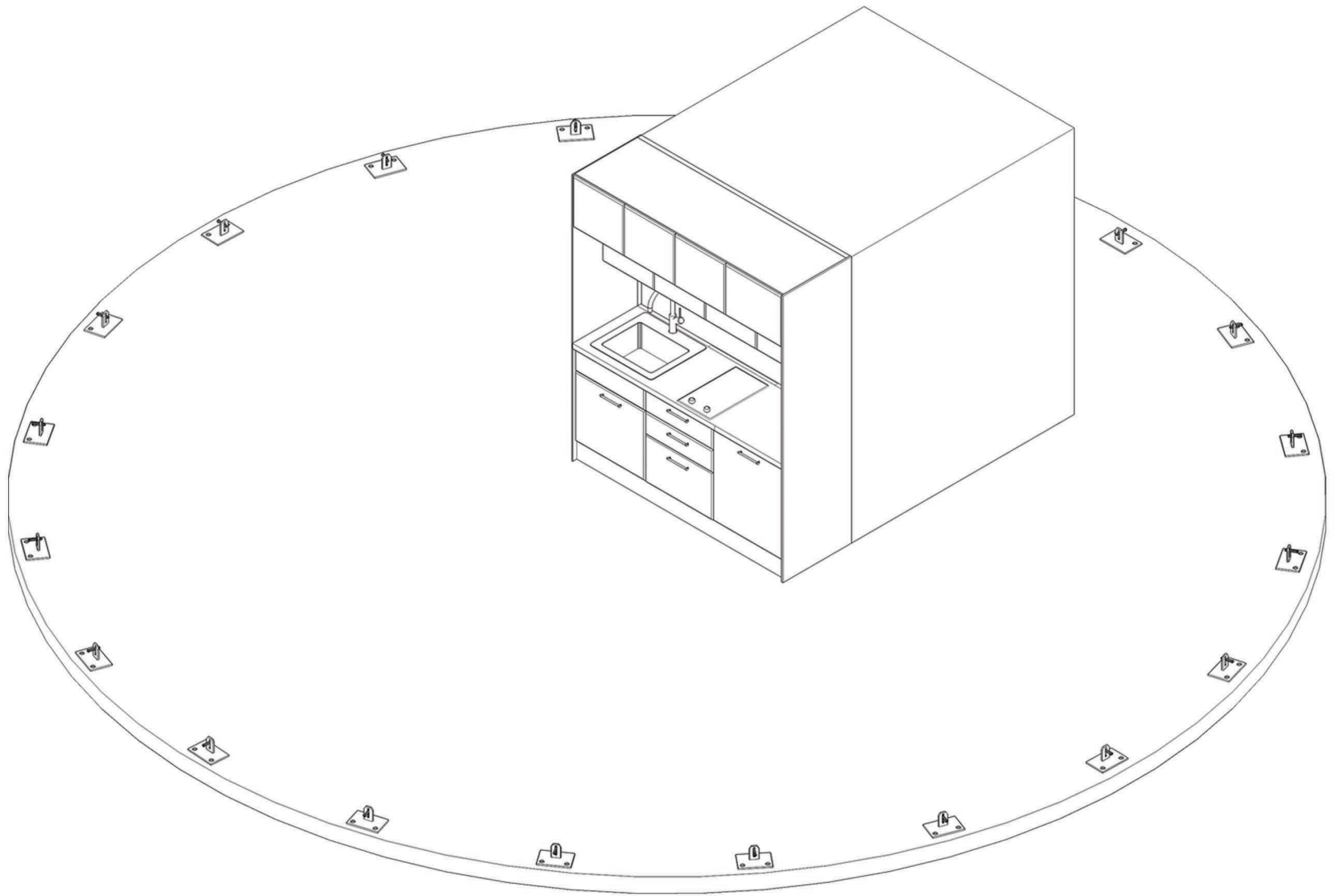

- Put the drawer back in its place.

STEP 8

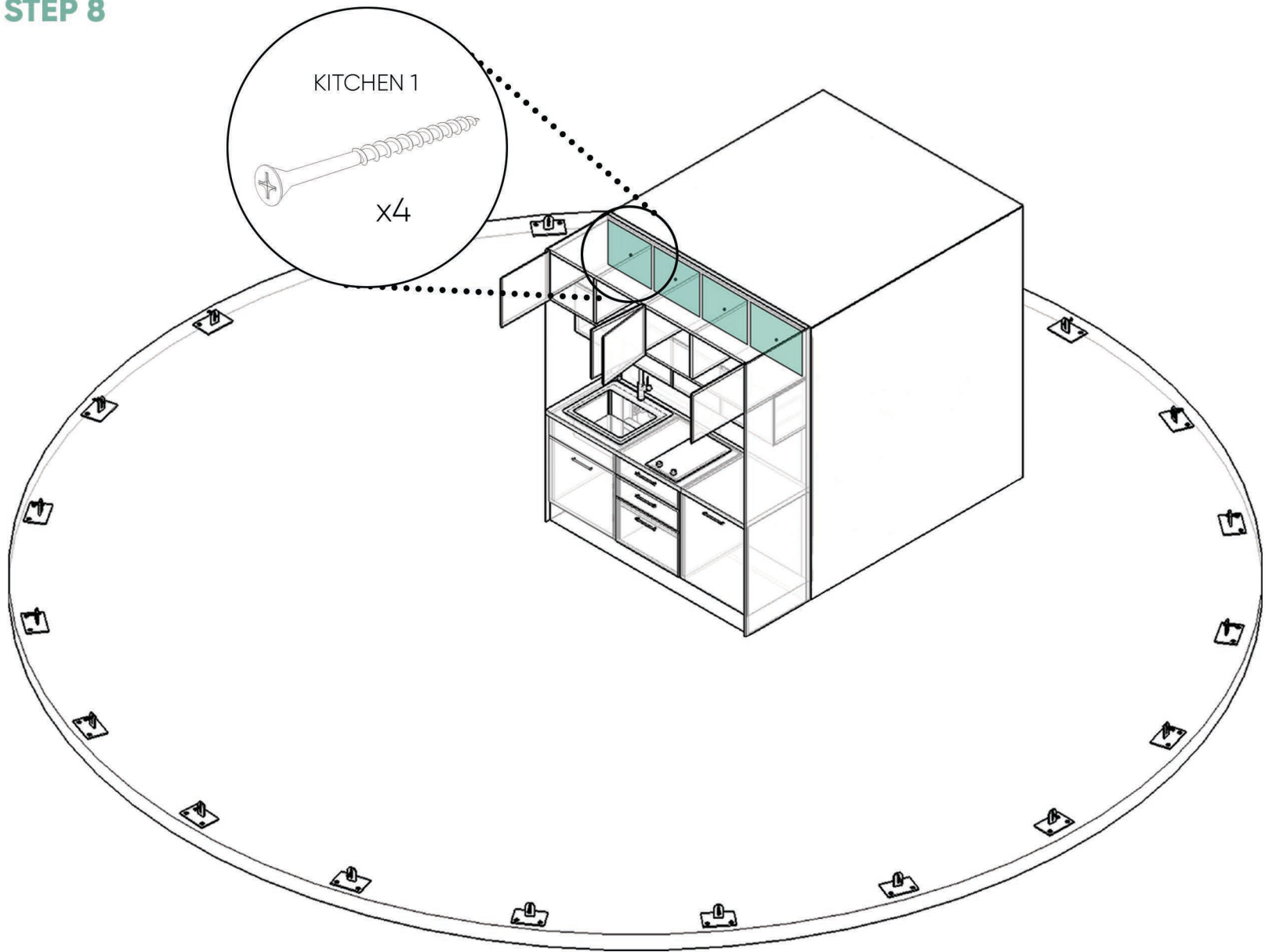

- Open the upper left cupboard and screw the screw through the back of the cupboard to connect the kitchen module with the bathroom module. Repeat the same for the rest of the cabinets.