

FDOMES MODULES

BEDROOM – ASSEMBLY GUIDE

STEP 1

Place the elements C and D against the wall of the bathroom module as presented in the drawing.

Attach the element A to the top of the element B and tighten it using the screws marked bedroom 1.

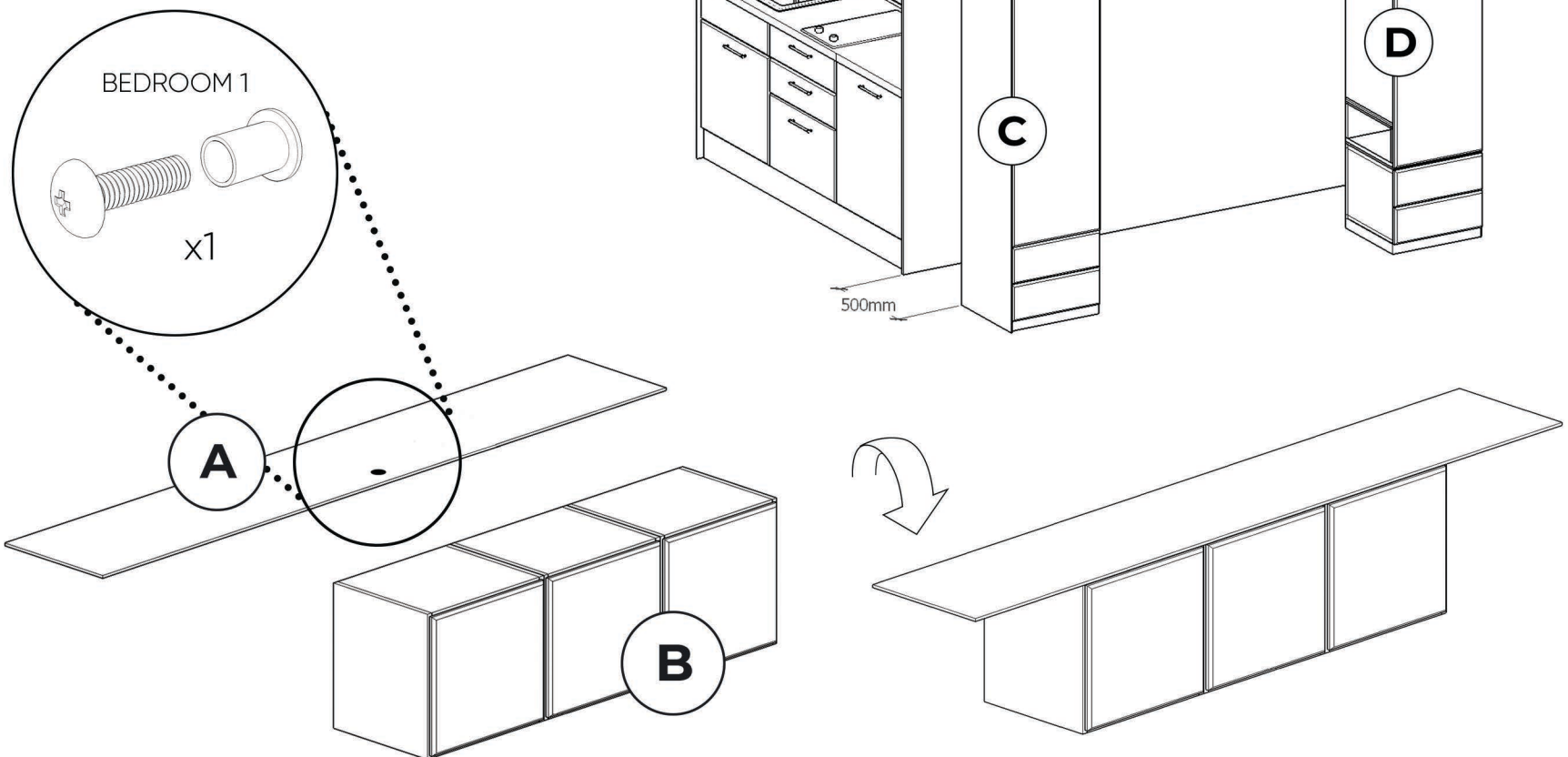

STEP 2

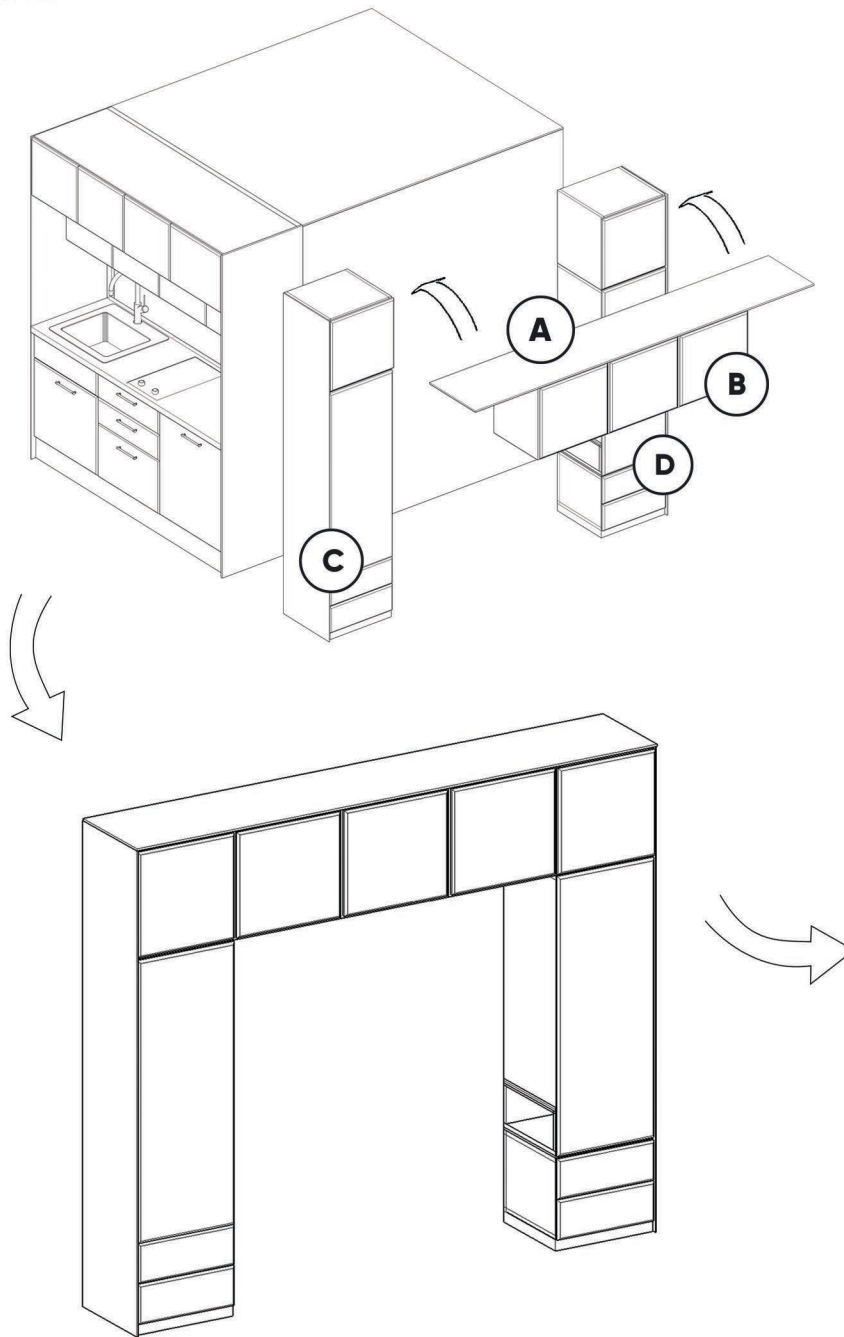

Place the assembled elements A and B on the top, between the elements C and D, and open the doors of the cabinets (as shown in the picture). Align all the elements and screw them (with the screws marked "bedroom 1") through the holes in the side walls of the cabinets.

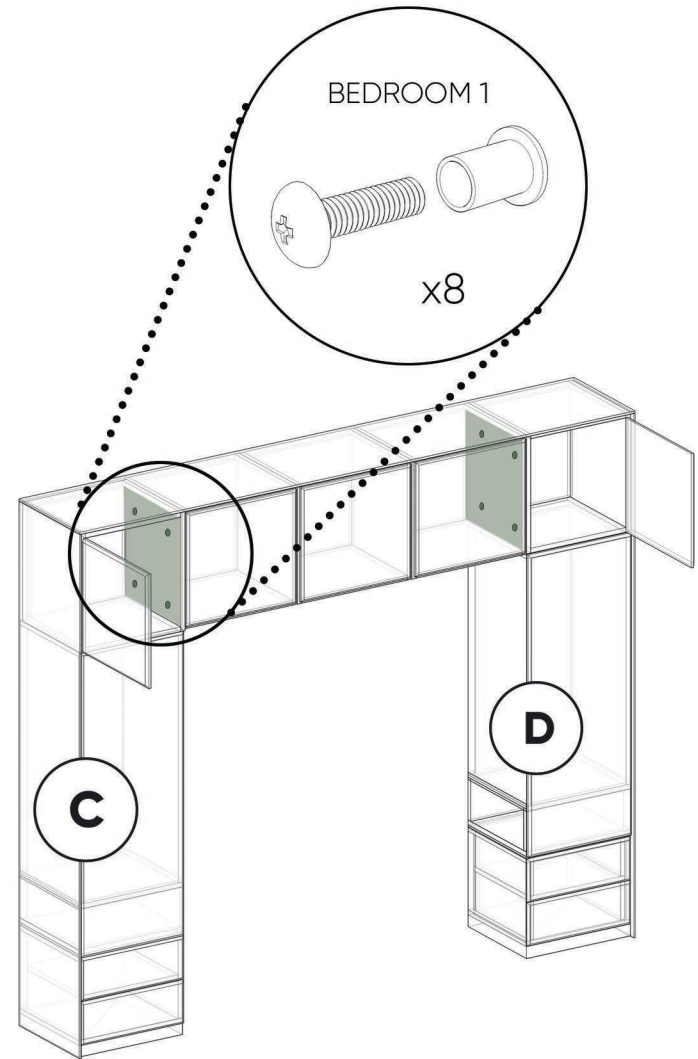

STEP 3

Connect the lighting cable plugs and power plugs in the marked places at the back of the module.

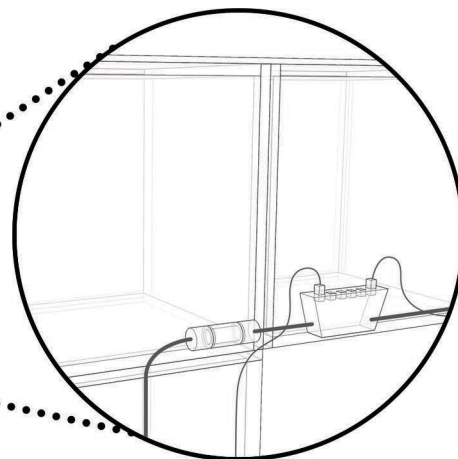
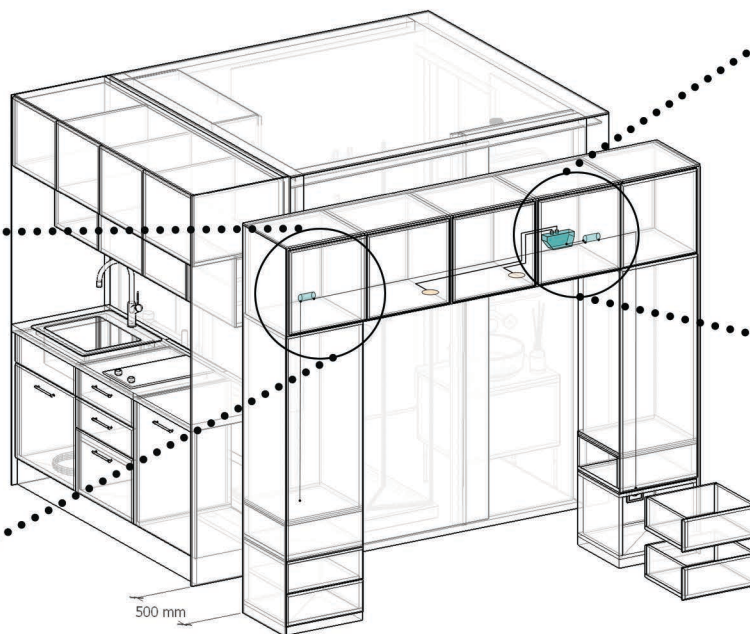
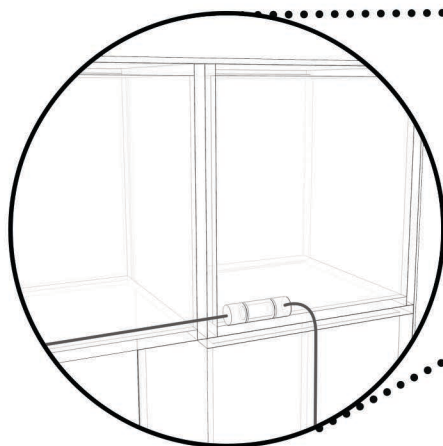

Pull out and remove both drawers from the element D.

Move the bedroom module to the bathroom module and, using the adjustable feet, level it so that it aligns with the edges of the bathroom and kitchen module.

Through the opening in the back wall of the wardrobe (D) located behind the drawers, insert the plug into the socket located in the bathroom module.

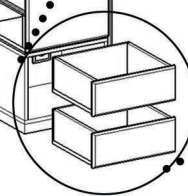
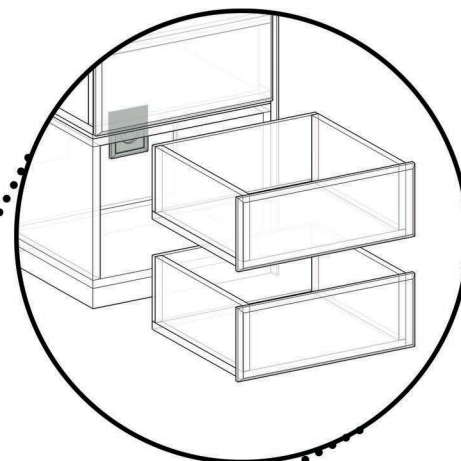
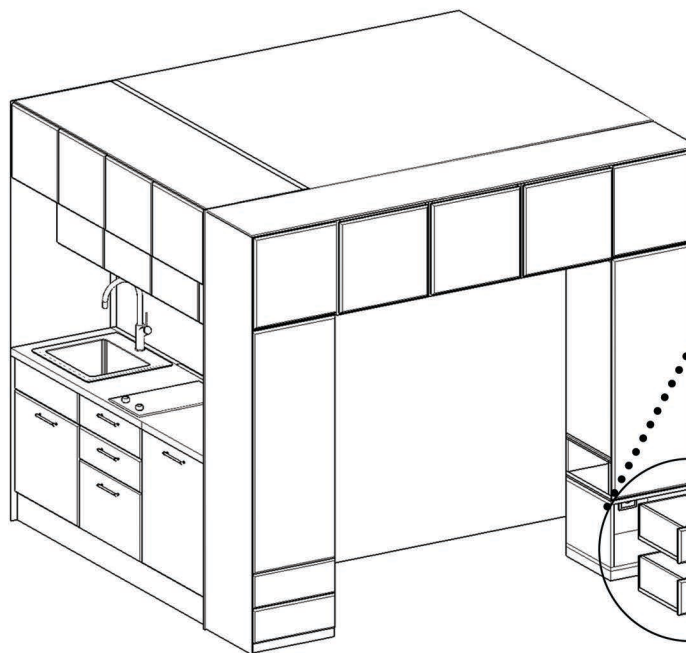

STEP 4

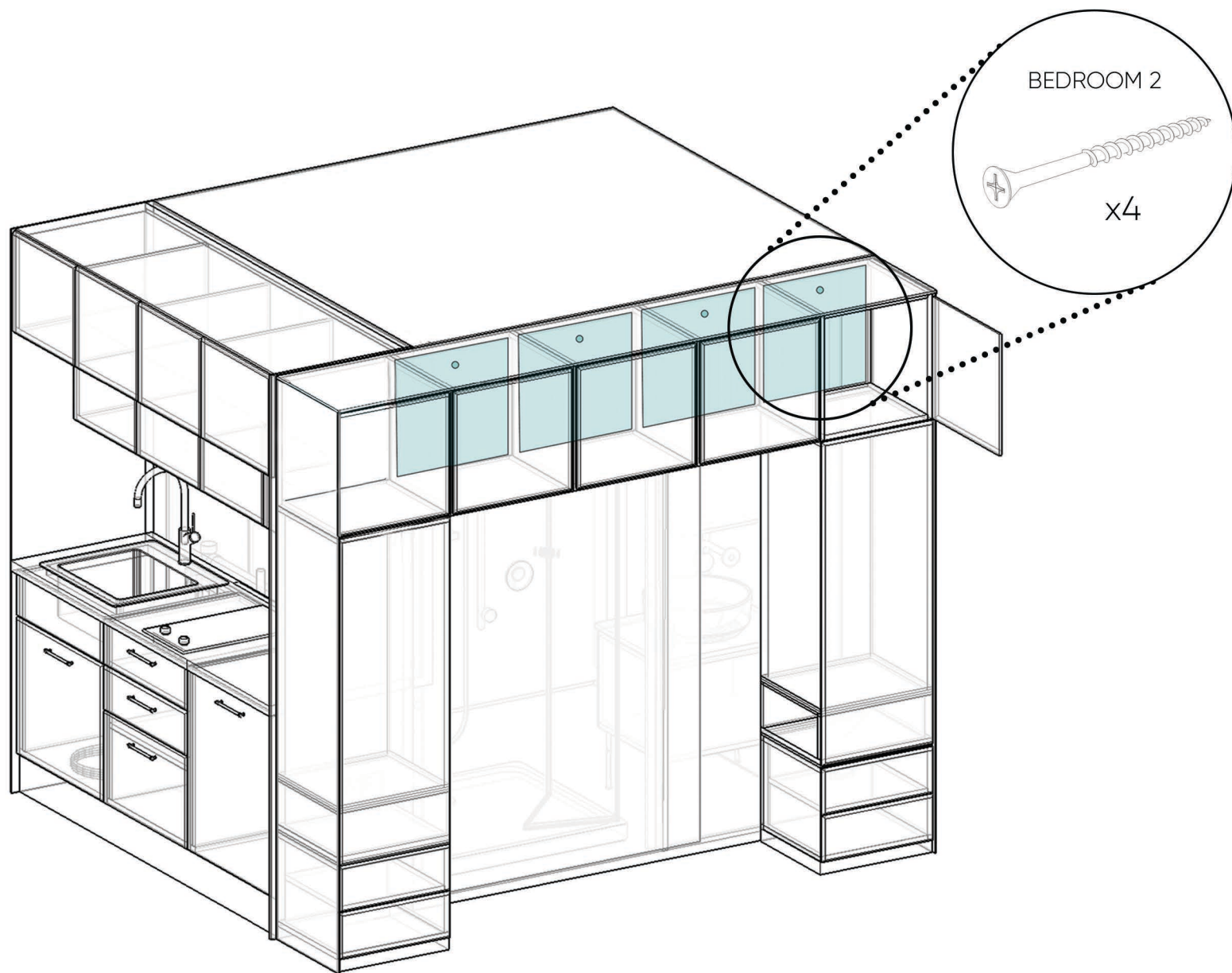

- Open the upper right cupboard and screw in the back of the cupboard so as to connect the bedroom module with the bathroom module. Repeat the same for the rest of the upper cabinets.

STEP 5

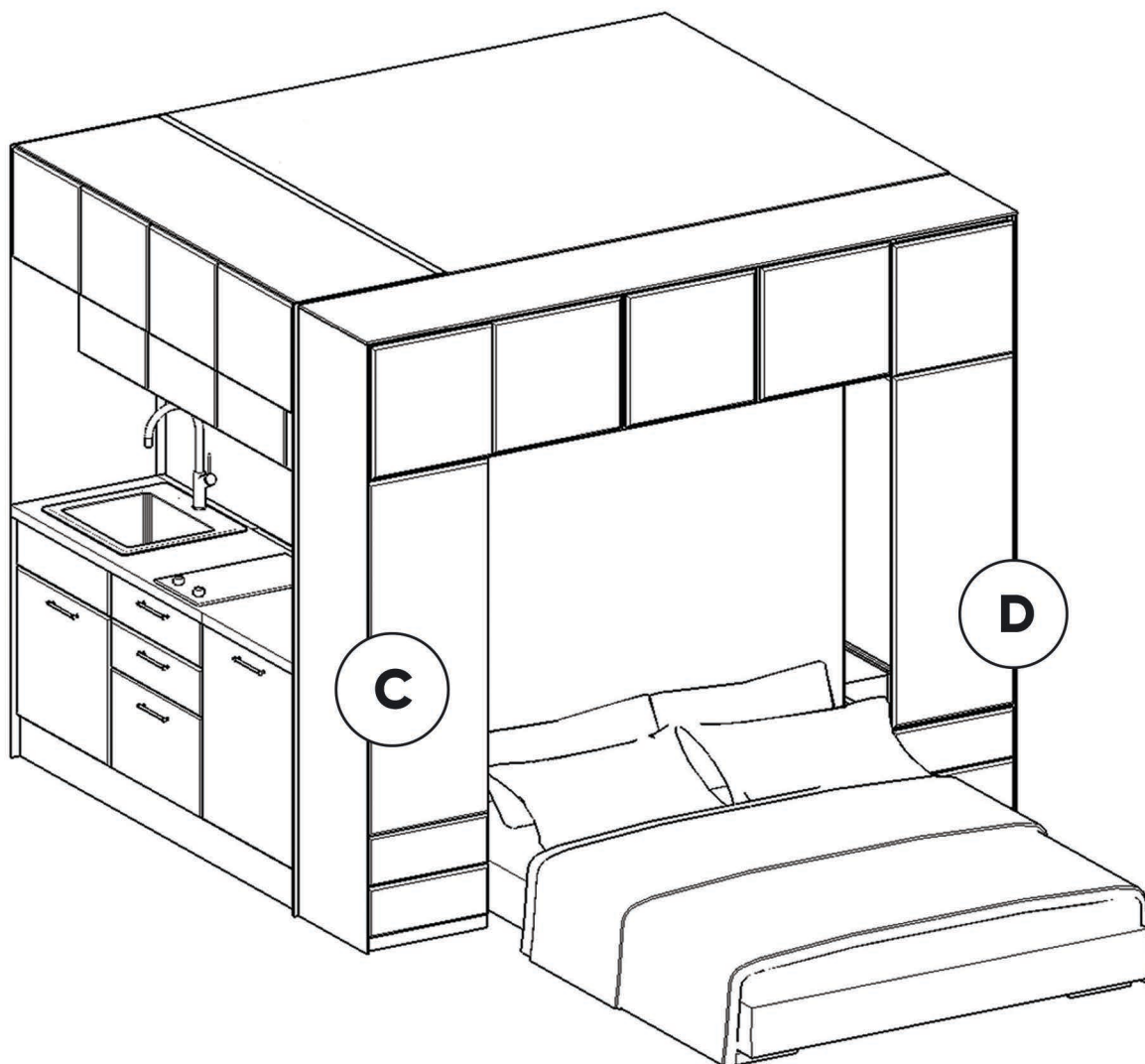

- Assemble the bed base according to the attached instructions.
- Insert the bed between the elements C and D, screw the legs to the bed frame.